

## Temporary Covers

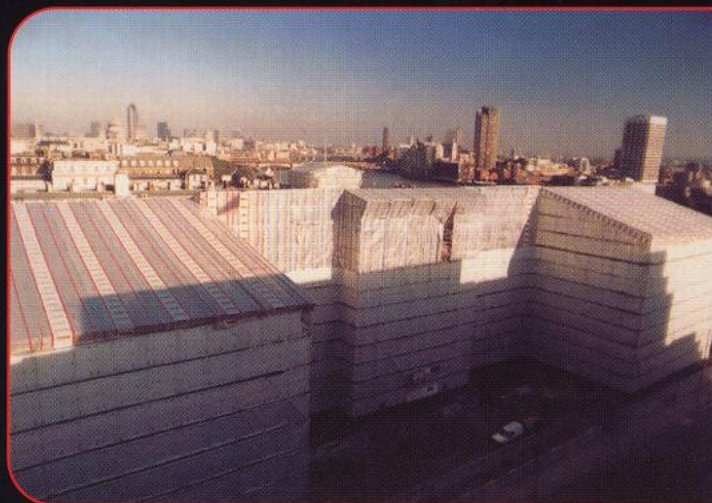

*Protect your investment and allow construction work to continue during bad weather.*

- Versatile
- Crane Handled
- Large & Small Covers
- Spans up to 60 feet
- Fast to erect

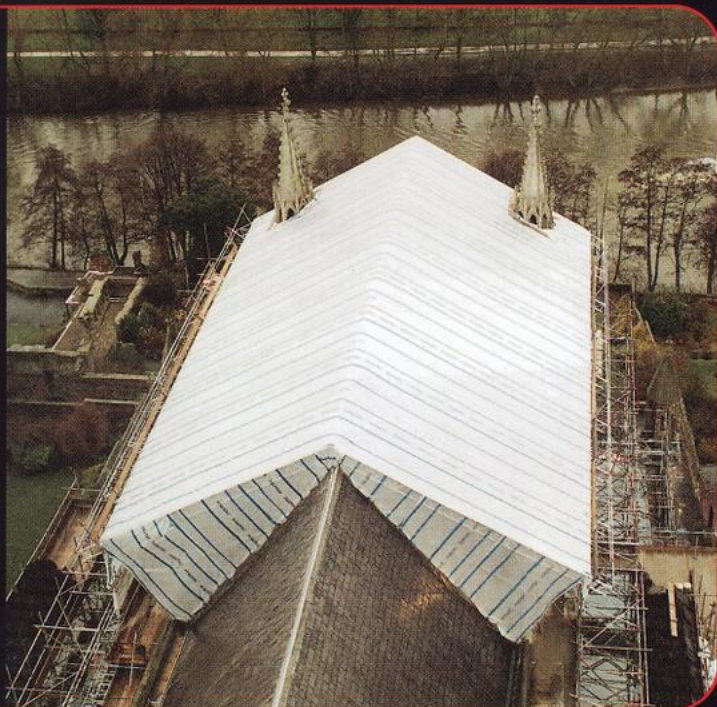

# HAKITEC

## Temporary Covers

The Hakitec weather protection system has been designed to provide a fast and easy to erect light-weight temporary cover. The Hakitec system is a series of versatile components which can be rapidly assembled to fit any structure's layout and shape to achieve maximum protection against the elements.

### Program Reliability

- Uninterrupted work schedule.
- Dramatically improved deployment of both men and materials
- Improved cost control
- Faster turn-round of work
- Can be fixed to any type of scaffold
- Creates clear working environment with natural light, eliminating the need for temporary lighting
- Proven to enhance program reliability and profitability in hundreds of installations

### Operational Effectiveness

- Unique sealing method results in a secure structure
- Improved quality of work
- Significant environmental benefits
- Helps adherence to statutory requirements

### Speed and Versatility

- Quick to erect and move with or without cranes. On large concrete foundation areas, can be repositioned manually using caster wheels.
- Saves valuable site storage space
- Temporary access through the system is easily achieved
- Adaptable to all structure shapes and sizes.



### The HAKITEC system can provide temporary shelters for:

- GROUND WORKS
- POWER FLOATING OPERATIONS
- PLANT MAINTENANCE
- MATERIAL STORAGE
- SITE AND PLANT YARD WORKSHOPS
- SPANS UP TO 60 FEET

## Erection Procedure: Safe, Simple, Effective

The Hakitec erection procedures have been designed to enable the scaffolder to install a temporary roof structure safely, efficiently and effectively.

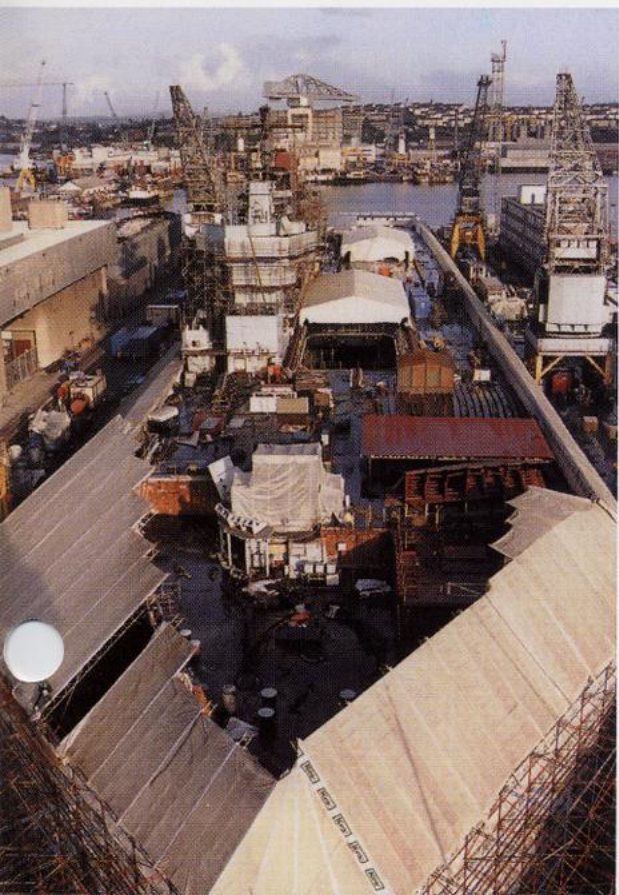
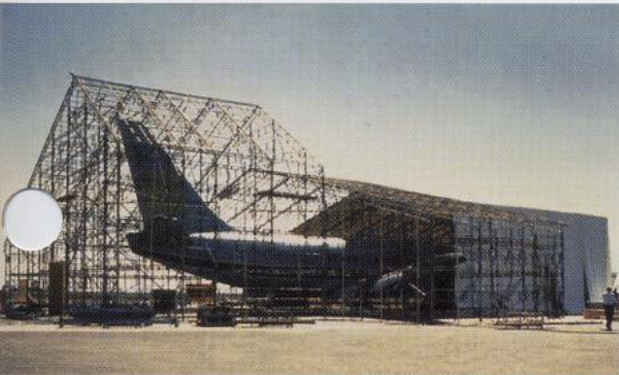

**1**

Assembled trusses are simply fixed to scaffold structure with standard couplers.



**2**

With the aluminum trusses in position, fixing beams are connected to the top tube.

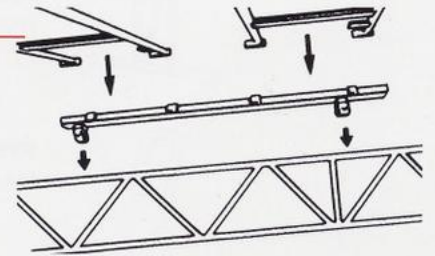

**3**

Purlin frames are set into lugs on the fixing beams. Locking devices are secured before proceeding.

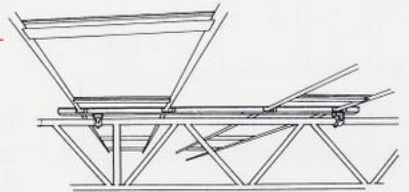

**4**

Hakitec sheeting is easily rolled over purlin frames and secured with fixing plates.

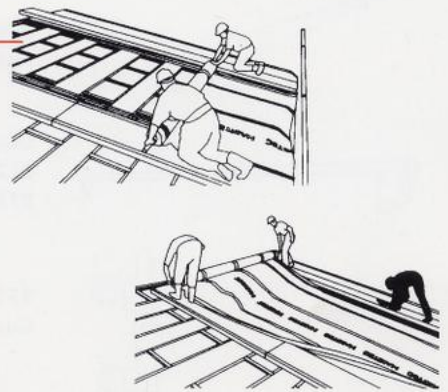

**5**

Fixing plate is screwed into position.

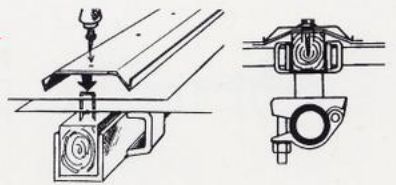

**6**

For greatest safety, purlin frames are installed as guardrails.

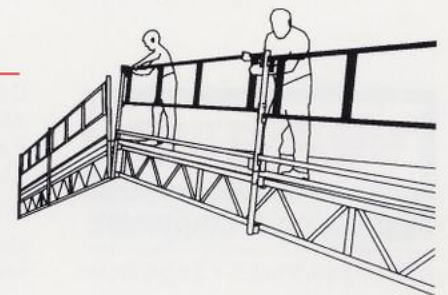

# Hakitec System Components

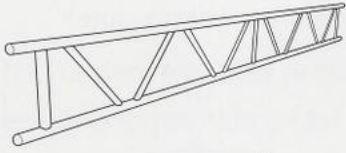

Aluminum Lattice Beam  
**4032410** 4.1m / 13'7"  
**4032610** 6.1m / 20'

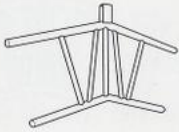

**7203100**  
 Ridge Frame Connector — 15°

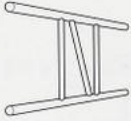

**7203200**  
 Straight Connecting Frame



**9092391**  
 Pin for Fixing Beam

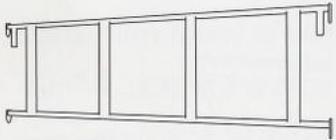

Purlin Frame, Galvanized  
**7052245** 2.45m / 8'  
**7052300** 3m / 9'10"



Fixing Beam  
**2511221** 1.9m / 5'3"  
**2511231** 0.95m / 3'1"



**2591201**  
 Fixing Plate



Guardrail, Galvanized  
**8722250** 2.45m / 8'  
**8722300** 3m / 9'10"



**2511289**  
 Guardrail Post Adapter

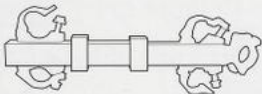

**2563100**  
 Double Truss Clamp,  
 Painted



*Hakitec's light weight and exceptional strength make it possible to construct entire sections that can be simply rolled along as work progresses.*



## For information or to place an order contact:

Branches	Phone Numbers	Fax Numbers
Dealer Sales	(800) 321-3150	(216) 267-9562
Akron, OH	(800) 676-9226	(330) 785-3921
Atlantic City, NJ	(800) 273-1056	(609) 646-7808
Canton, OH	(800) 927-9226	(330) 497-0572
Carson, CA	(800) 251-4503	(310) 538-1003
Charleston, WV	(800) 678-9226	(304) 744-0349
Cleveland, OH	(800) 927-7502	(216) 351-9009
Columbus, OH	(800) 736-9226	(614) 486-7443
Indianapolis, IN	(888) 284-8744	(317) 951-8715
Minneapolis, MN	(800) 347-9356	(651) 697-0254
Phoenix, AZ	(888) 345-9226	(480) 507-8844
Pittsburgh, PA	(800) 422-9284	(412) 823-4840
San Diego, CA	(800) 734-9226	(619) 566-5780
San Diego Shipyard	(888) 472-2336	(619) 233-0802
Seattle, WA	(866) 642-8216	Call for Fax
Youngstown, OH	(888) 415-9737	(330) 792-2265

**WACO**<sup>®</sup>  
**Scaffolding & Equipment**  
 RENTALS • SALES • ERECTION

Corporate Office  
 4545 Spring Road  
 P.O. Box 318028  
 Cleveland, Ohio 44131  
**800-321-3150**  
 Visit Our Web Site  
[www.wacoscaf.com](http://www.wacoscaf.com)

U.S. Distributor of  
 Haki Temporary Covers

